

manhattan • chilled display multideck



Image: MCASMD3-GO



Stock Code	Capacity (gn)	Overall Size (mm)	Weight (kg)	Wattage (kw)
Chilled 2 tier multideck				
MC2ASMD2-GO	2/1	825 x 660 x 560h	110	2.4
MC2ASMD3-GO	3/1	1175 x 660 x 560h	144	2.5
MC2ASMD4-GO	4/1	1525 x 660 x 560h	180	2.7
MC2ASMD5-GO	5/1	1875 x 660 x 560h	206	2.7
Chilled 3 tier multideck				
MC3ASMD2-GO	2/1	825 x 660 x 693h	144	2.4
MC3ASMD3-GO	3/1	1175 x 660 x 693h	161	2.5
MC3ASMD4-GO	4/1	1525 x 660 x 693h	204	2.7
MC3ASMD5-GO	5/1	1875 x 660 x 693h	248	2.7
Chilled 4 tier multideck				
MC4ASMD2-GO	2/1	825 x 660 x 853h	155	2.4
MC4ASMD3-GO	3/1	1175 x 660 x 853h	176	2.5
MC4ASMD4-GO	4/1	1525 x 660 x 853h	219	2.7

- Chilled display multidecks are designed for self-help service.
- Gentle flow of convected air maintains pre-chilled food at a safe regulated temperature.
- Double-glazed, full height side hinged doors included as standard.
- The angle of the display deck can be adjusted for enhanced presentation.
- Gantry mounted controller installed on operators side (GO) - Doors.
- The gantry controller can be installed on customer side (GC) - Fixed Back.

technical specifications

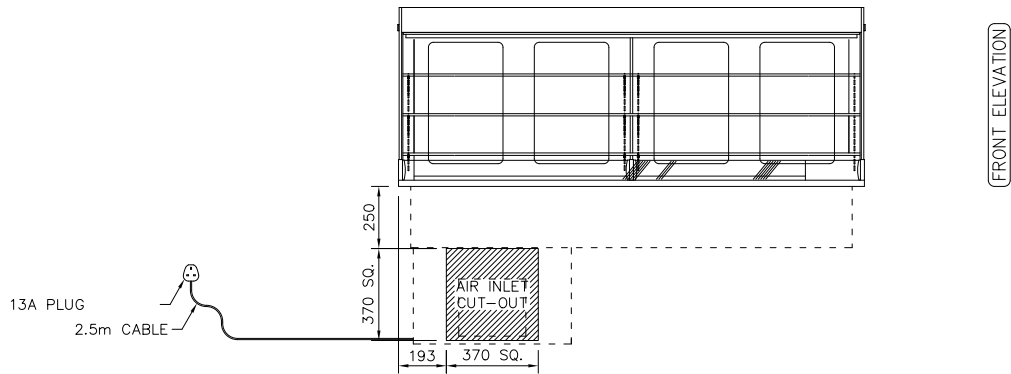

FRONT ELEVATION

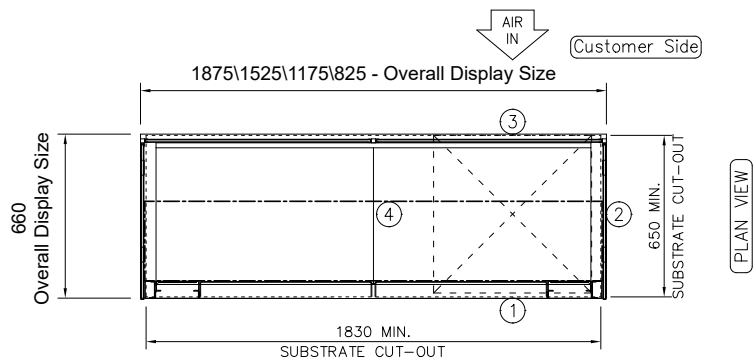

PLAN VIEW

NOTE:
 IF DISPLAY IS TO BE FLUSH
 MOUNTED INTO WORKTOP,
 ADD 4 - 6mm TO DISPLAY
 SIZES FOR WORKTOP CUT-OUT

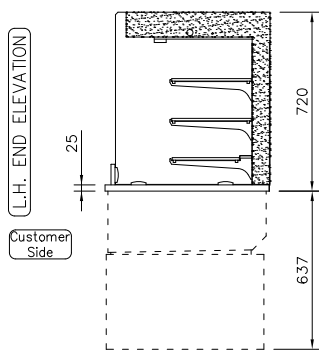

L.H. END ELEVATION

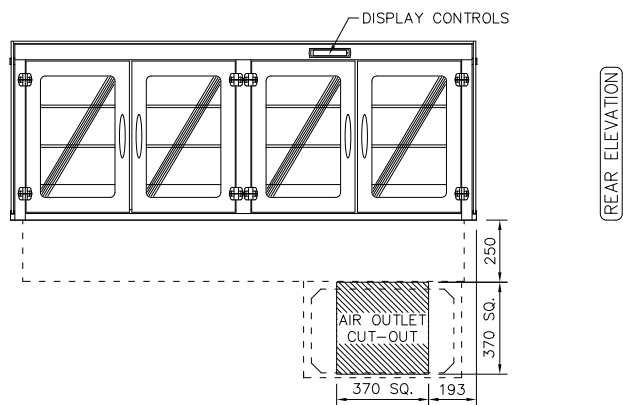

REAR ELEVATION

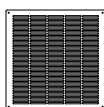

CUSTOMER & OPERATOR SIDE FASCIA
 PANELS MUST BE REMOVABLE FOR
 MAINTENANCE ACCESS
 SUPPLIED WITH 400mm SQ. STAINLESS
 STEEL AIR INLET/OUTLET GRILLES